

APPENDIX A—LAKE AND RIVER CLASSIFICATIONS

DNR LAKE CLASSIFICATIONS

LAKE #	LAKE NAME	SEC.	TWP.	RNG.	CLASS.
11-0307	Norway Lake	29-31; 25,36	138	29; 30	GD
11-1242	Pine River (S. TO 371)	6	137	29	GD
11-1242	Pine River(Norway l. to 371)	30, 31	138	29	GD

APPENDIX B-- CASS COUNTY ROAD SPECIFICATIONS

A. DESIGN CRITERIA

FUNCTIONAL CLASS	ROAD AUTHORITY	MINIMUM RIGHT-OF-WAY
Local Road	County in unorganized township Township, Municipality, or Private	66 feet
Cartway	Private	33 feet
Frontage Road	County, County in unorganized Township, Municipality, or Private	50 feet
Cul-de-sac	Same as connecting roadway	60 feet

B. REQUIRED CLASS 5 AGGREGATE ADDITION BY SUBGRADE SOIL TYPE

SUBGRADE SOIL	SAND. GRAVEL	ALL OTHER SOILS
Aggregate surface or pavement	4 Inches	6 Inches

C. TYPICAL CARTWAY AND LOCAL ROAD CROSS SECTIONS

CARTWAY

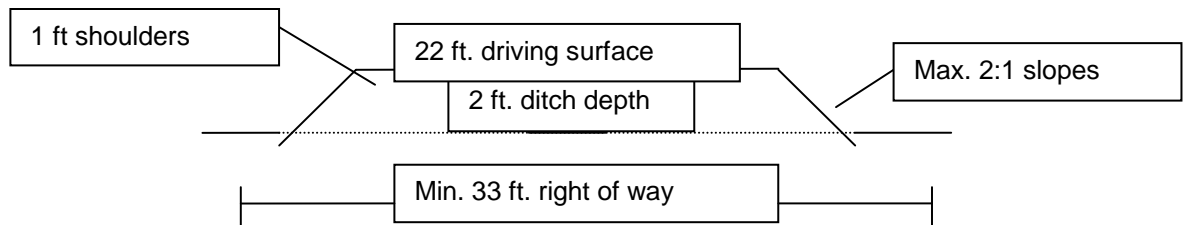

LOCAL ROAD

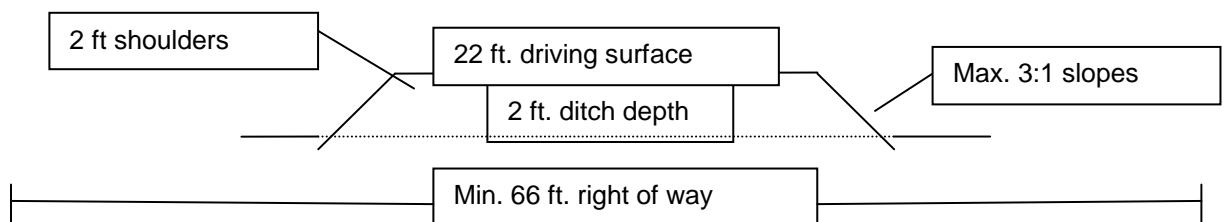

D. ADDITIONAL SPECIFICATIONS

1. AGGREGATE DRIVING SURFACES SHALL BE STABILIZED GRAVEL THAT MEET:
 - a. Minnesota Department of Transportation specifications 3138, Class 5, except that the County Engineer reserves the right to eliminate the 10% crushing requirement where crushing material is not available.
2. Bituminous driving surfaces shall meet Minnesota Department of Transportation specifications 2331.

APPENDIX C: Zoning Map

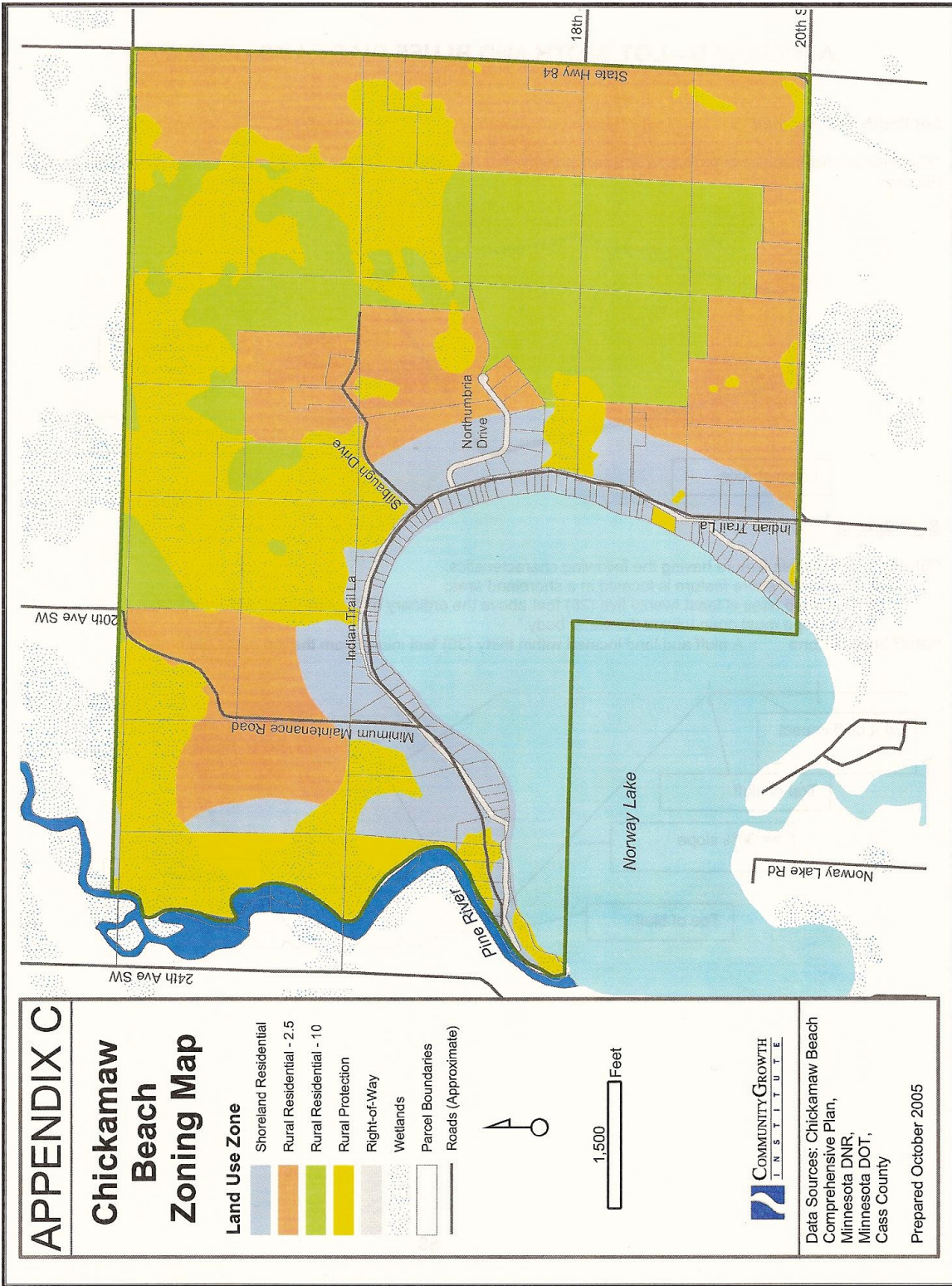

APPENDIX C

Chickamaw Beach Zoning Map

- Land Use Zone**
- Shoreland Residential
 - Rural Residential - 2.5
 - Rural Residential - 10
 - Rural Protection
 - Right-of-Way
 - Wetlands
 - Parcel Boundaries
 - Roads (Approximate)



1,500 Feet

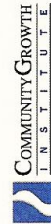

Data Sources: Chickamaw Beach Comprehensive Plan, Minnesota DNR, Minnesota DOT, Cass County

Prepared October 2005

APPENDIX D—LOT WIDTH AND BLUFF DIAGRAMS

Lot Width, Non-riparian

“The shortest distance between side lot lines as measured at the midpoint of the longest axis of said lot perpendicular to that axis.”

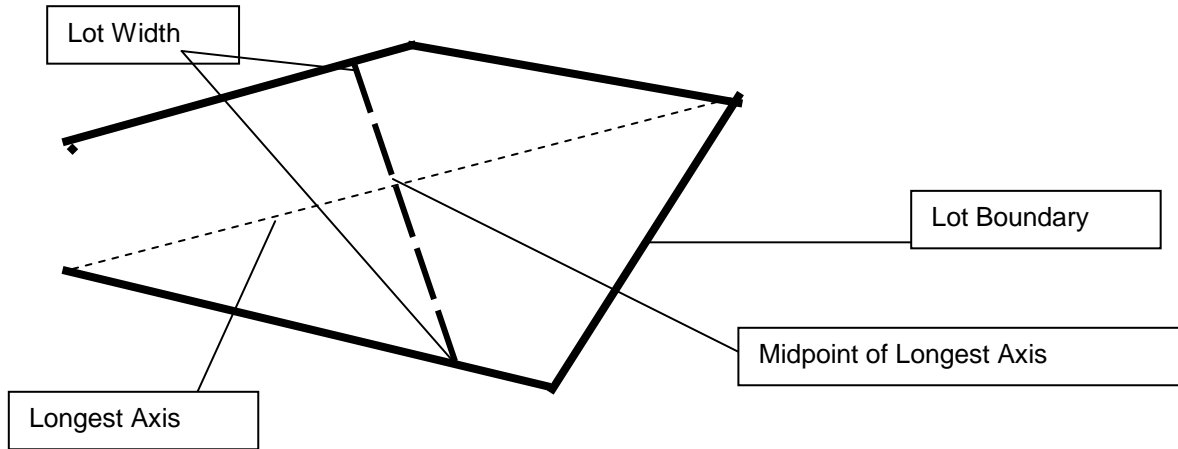

Bluff Criteria

“Bluff: A topographic feature having the following characteristics:

- A. Part or the entire feature is located in a shoreland area;
- B. The slope rises at least twenty five (25) feet above the ordinary high water level of the waterbody;
- C. The slope must drain toward the water body.”

“Bluff Impact Zone : A bluff and land located within thirty (30) feet inland from the top of the bluff

